

## MTX70 — CONTROLS AND COMPONENTS

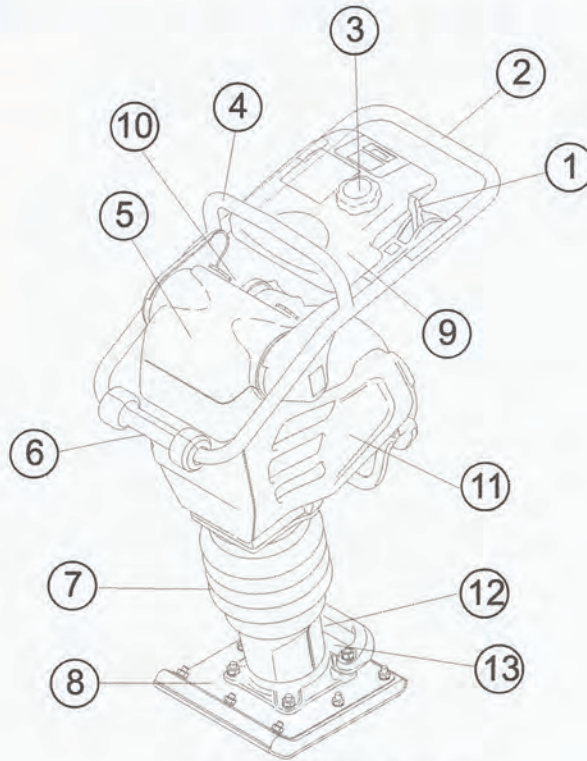

Figure 1. MTX70 Rammer

Figure 1 shows the location of the controls and components for the MTX70 Tamping Rammer. The functions of each control is described below:

1. **Combination (Throttle) Lever** – Used to adjust engine speed (rpm). Move lever forward (**SLOW**) to reduce engine speed, move lever back toward operator (**FAST**) to increase speed. Always operate the rammer at full speed (rpm).
2. **Handle** – To operate rammer, **GRIP** handle assembly firmly on both sides.
3. **Fuel Tank Cap** – Remove this cap to add unleaded gasoline to the fuel tank. Make sure cap is tightened securely. **DO NOT** over fill.
4. **Hook** – Used to lift rammer for transporting.
5. **Air Cleaner Cover** – Protects the air cleaner which prevents dirt and other debris from entering the engine.
6. **Roller** – Allows rammer to be moved around easily by rolling the unit.
7. **Bellows** – Reservoir for oil bath.
8. **Foot** – Laminated wood with tempered steel plate for superior shock absorption.
9. **Fuel Tank** – Holds the fuel for the unit (up to 3.2 quarts)
10. **Muffler** – reduces the noise of the engine when running.
11. **Engine** – this unit uses a Honda GX100UKRBF gasoline engine.
12. **Oil Gauge (Sight Glass)** – Indicates the level of oil in the oil bath reservoir.
13. **Drain Valve** – Open this valve to remove oil from the bellows.



### WARNING

Adding fuel to the tank should be accomplished only when the engine is stopped and has had an opportunity to **cool down**. In the event of a fuel spill, **DO NOT** attempt to start the engine until the fuel residue has been completely wiped up, and the area surrounding the engine is dry.



## MTX70 — SPECIFICATIONS

Table 1. MTX-70 Rammer Specifications

Overall Height	39.37 in. (1000 mm)
Overall Width	13.78 in (350 mm)
Over Length	31.02 in (788 mm)
Shoe Size	13.4 x 11.2 (340 x 285 mm)
Fuel Tank Capacity	3.2 qt. (3 liters)
Lubrication Oil Capacity	0.8 quart (0.75 liter)
No. of Impacts Per Second	10.7 - 11.5
Impact Force	2,855 lb (12.7 kN)
Impact Plate Stroke	2 -3.15 in (50 - 80 mm)
Operating Weight	165.34 lbs. (75 kg)

Table 2. Engine Specifications

Model	Honda GX100UKRBF Engine
Type	Air-Cooled 4 Stroke, Overhead camshaft, single cylinder gasoline engine
Piston Displacement	6.0 cu.in. (98 cc)
Max. Output	3.0 hp/3,600 rpm (2.2 KW)
Max. Governed Speed, No Load	3,800 - 4,100 rpm
Cooling System	Air-Cooled
Engine Oil Capacity	0.3 qt. (0.28 liters)
Fuel	Unleaded gasoline
Lubricant for Engine	Automobile Oil; Class SE or higher
Starting System	Recoil Starter
Spark Plug Type	NGK CR5HSB

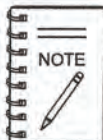

**Specifications are general and are subject to change without notice. If exact measurements are required, equipment should be weighed and measured.**